

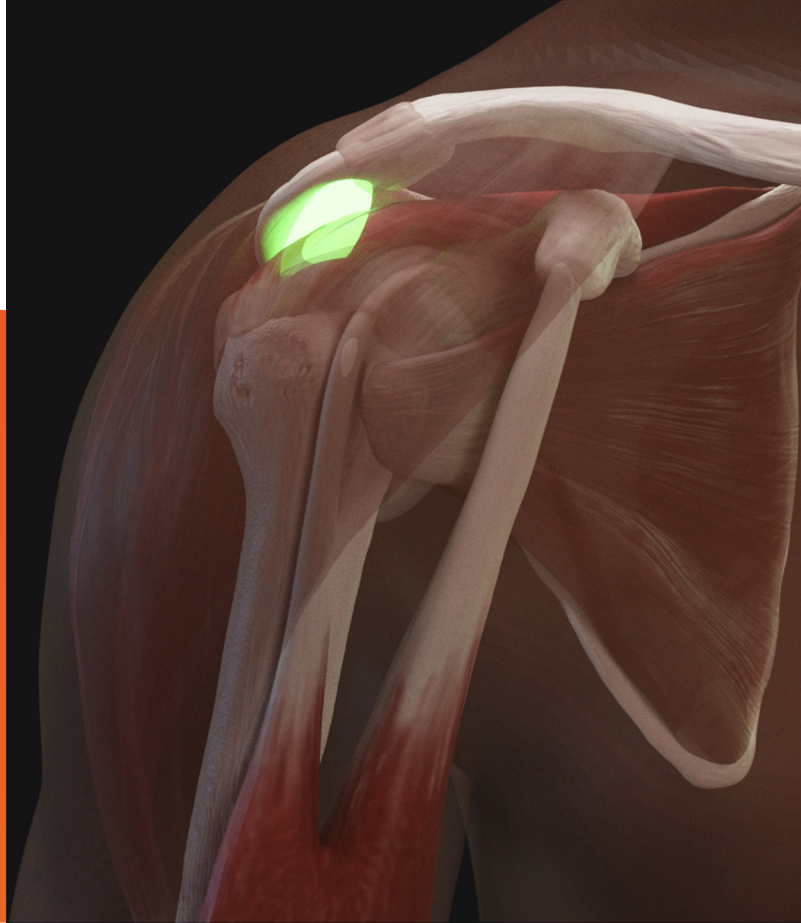

USER GUIDE



SHOULDER INJECTION TRAINER PALPATION GUIDED

This product is available in light & dark skin tones

70200

70219

70201

70220



FOR MORE SKILLS TRAINING PRODUCTS VISIT

limbsandthings.com

Sussex Street, St Philips, Bristol, BS2 0RA, UK | sales@limbsandthings.com | +44 (0) 117 311 0500

INDEX

PACKAGE SUPPLIED	3
TEST CERTIFICATION	4
SAFETY & CLEANING INSTRUCTIONS	6
QUICK START	7
• PUT BATTERIES IN	7
• CONNECTING THE TABLET	8
• PRACTICING	10
OTHER APP FEATURES	11
CARE & MAINTENANCE	12
• REMOVE & REATTACH THE SHOULDER	12
• CHANGING THE SKIN	13
• CHANGING THE BATTERIES	14

TAKE A LOOK
AT OUR **VIDEO**



VISIT THE WEBSITE
limbsandthings.com

OR YOUTUBE CHANNEL
youtube.com/limbsandthings

PACKAGE
SUPPLIED

Shoulder
Torso

70215
70226



Shoulder
Module

70212
70223



Shoulder Skin
(x1 Spare)

70210
70222



Needle Set

70108



Android Tablet
(Only Included with 70200/70219)



Elbow



AA Batteries (x2)

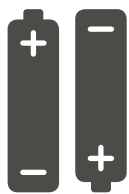

Carry Case



Notes

TEST
CERTIFICATION



EC DECLARATION OF CONFORMITY

In accordance with ISO IEC 17050-1 : 2010

We at
Limbs & Things Ltd

of

Sussex Street, St. Philips, Bristol, BS2 0RA

Declare under our sole responsibility that the product described below:

Brand and Model Name	Limbs and Things Shoulder Injection Palpation Guided Part numbers: 70200, 70219, 70201, 70220, 70212, 70223.
----------------------	-----------------------------------------------------------------------------------------------------------------

Has been tested and is in conformity with the following standards:

SUBJECT	STANDARD
Electrical Safety	LVD Directive – 2014/35/EU EN 60950-1: 2006 + A11:2009 + A1:2010 + A12:2011 + A2:2013 For Information Technology equipment.
Electromagnetic Compatibility	EMC Directive – 2014/30/EU EN 55032: 2015 Electromagnetic compatibility of multimedia equipment EN 55032:2015 Radiated emissions: Class B 30 MHz to 1 GHz EN 55032:2015 Radiated emissions: Class B 1 GHz to 6 GHz EN 61000-4-2:2009 Electrostatic Discharge +/- 4.0 kV Contact / +/- 8.0 kV Air EN 61000-4-3:2006 + A1:2008 + A2:2010
Radio performance	EN 300 328 V1.9.1:2015-02
RoHS	RoHS - Directive 2011/65/EU, as amended (by Directive 2015/863)

Thereby meeting the essential requirements of directive (RED) (2014/53/EU)

I hereby declare that the equipment named above has been designed to comply with the relevant sections of the above referenced Standards and meets all essential requirements of the RTTE Directive.

Signed: Nick Hull
Position: Managing Director
Location: Limbs & Things Ltd, Bristol, England
Date: 23 August 2021

Signature



Limbs & Things Ltd

DECLARATION OF CONFORMITY

In accordance with UK Government Guidance

We at
Limbs & Things Ltd

of

Sussex Street, St. Philips, Bristol, BS2 0RA

Declare under our sole responsibility that the product described below:

Brand and Model Name	Limbs and Things Shoulder Injection Palpation Guided Part number: 70201 / 70200
----------------------	------------------------------------------------------------------------------------

Has been tested and is in conformity with the following standards:

SUBJECT	STANDARD
Electrical Safety	Electrical Equipment (Safety) Regulations 2016 BS EN 60950-1: 2006 + A11:2009 + A1:2010 + A12:2011 + A2:2013 For Information Technology equipment.
Electromagnetic Compatibility	Electromagnetic Compatibility Regulations 2016 BS EN 55032: 2015 Electromagnetic compatibility of multimedia equipment BS EN 55032:2015 Radiated emissions: Class B 30 MHz to 1 GHz BS EN 55032:2015 Radiated emissions: Class B 1 GHz to 6 GHz BS EN 61000-4-2:2009 Electrostatic Discharge +/- 4.0 kV Contact / +/- 8.0 kV Air BS EN 61000-4-3:2006 + A1:2008 + A2:2010
Radio performance	Radio Equipment Regulations 2017 BS EN 300 328 V1.8.1:2012-06
RoHS	The Restriction of the use of certain Hazardous Substances in Electrical and Electronic Equipment Regulations 2012

I hereby declare that the equipment named above has been designed to comply with the relevant sections of the above referenced Standards.

Signed: Nick Hull
Position: Managing Director
Location: Limbs & Things, Bristol, England

Signature
Date: 05/11/21

SAFETY & CLEANING INSTRUCTIONS

READ THE SAFETY INSTRUCTIONS CAREFULLY BEFORE USING YOUR SHOULDER INJECTION TRAINER

DO's



Follow all instructions.
Keep these instructions.
Heed all warnings.

Use needles provided or near new needle of 21 gauge.
Package contains needles.



If a product is damaged or worn, it should be repaired by Limbs & Things. To arrange this, please contact your point of purchase who will be able to provide a repair quote.

Clean the product with a damp soft cloth or sponge, using only warm water with mild detergent.



Only use this product indoors.

DON'Ts



Do not install near any heat sources, do not expose the product to flames or use near naked flame sources. Do not use flammable solvents near or on this product.

Caution - Risk of explosion if battery is replaced with incorrect type. This product is intended for use with standard type AA Alkaline or similar non-rechargeable batteries. Check local guidelines for the correct disposal of batteries.



Do not inject the shoulder with liquids, or use this near water, this product contains electronics.

Do not over rotate/move the shoulder as this can damage the product.



The product is not a toy and must not be used by children or untrained staff.

STORAGE & TRANSPORTATION



Always ensure that the products are properly packed and secured during transportation and storage in order to prevent personal injury or damage to the product.

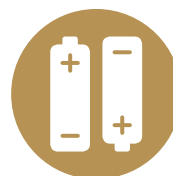

Remove the batteries if the product is going to be stored for a long period of time.

QUICK START

PUT BATTERIES IN

1 Remove shoulder from torso

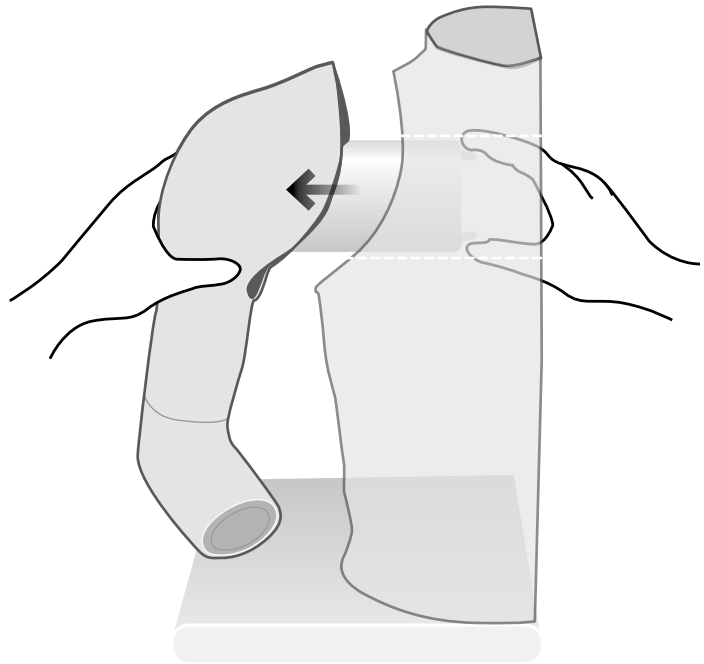
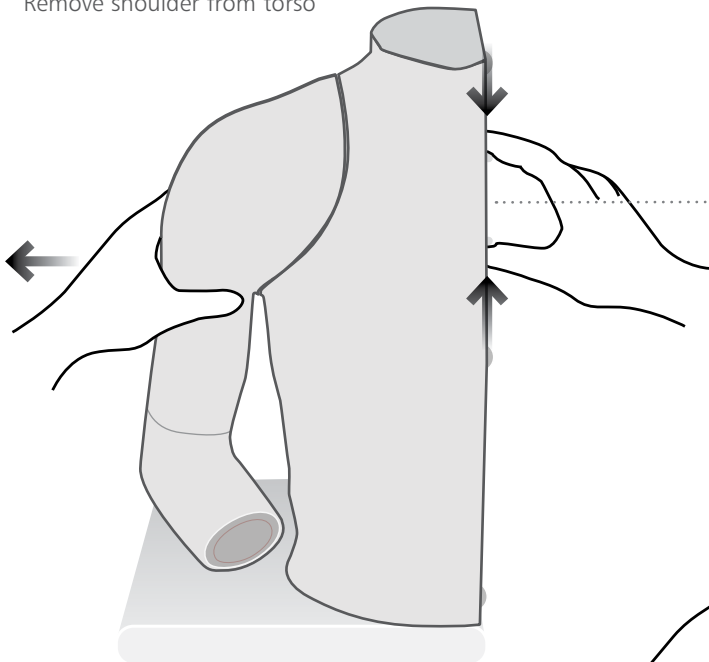

2 Insert the batteries and reattach the shoulder

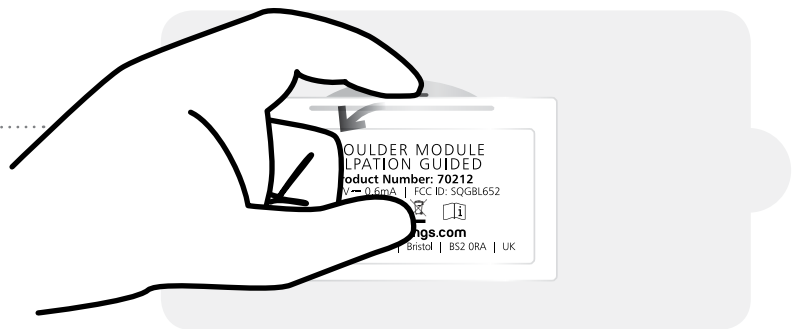
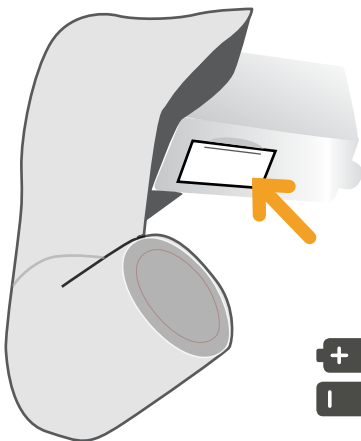

QUICK START

CONNECTING THE TABLET

1 Switch ON the shoulder 

2 Open the Shoulder Injection App.

Available as a free download on the Limbs & Things website.

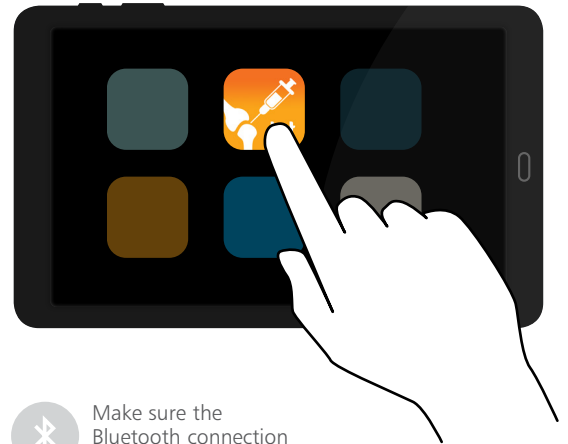
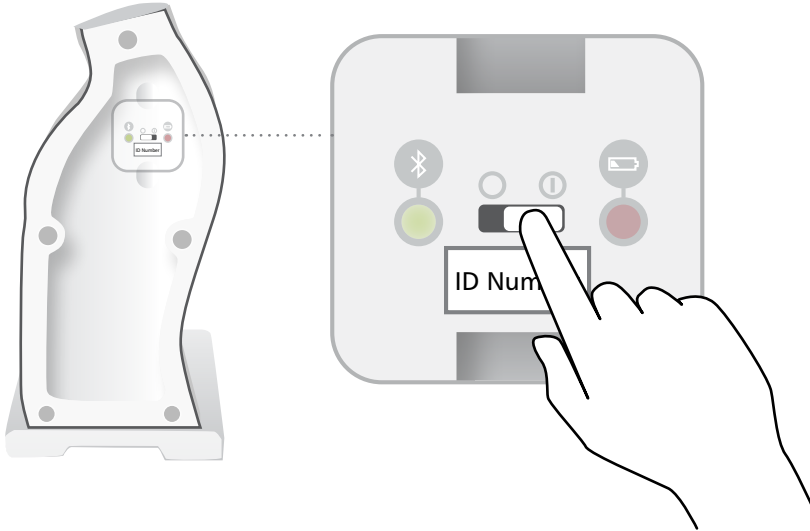

 Make sure the Bluetooth connection is enabled on your device



BLUETOOTH LIGHT



Shoulder OFF - No light

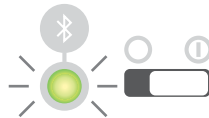

Shoulder ON - Light flashes fast
BROADCASTING

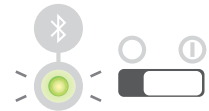

Shoulder ON - Light flashes slow
CONNECTED

3 Choose language

4 Submit registration details

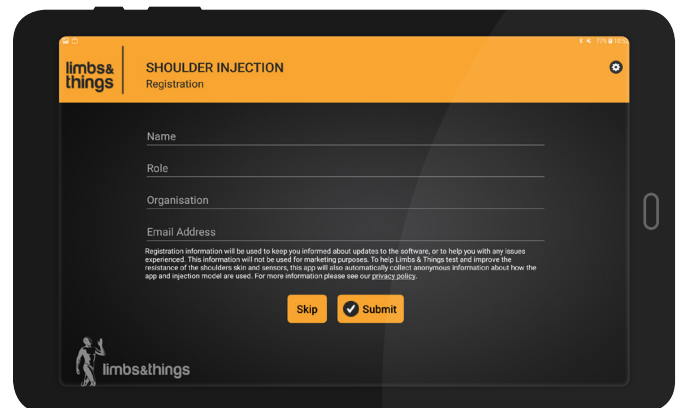
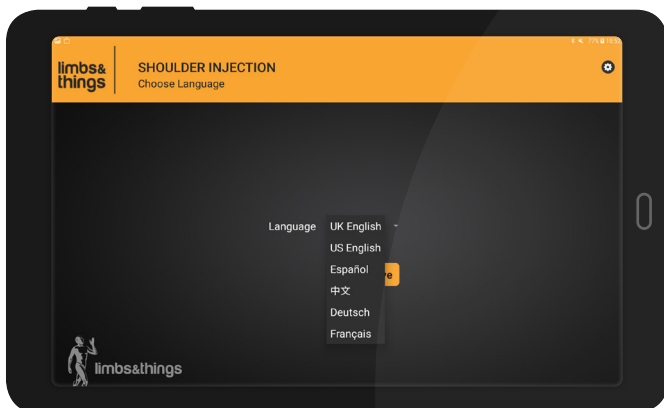

5 Select 'PALPATION GUIDED'

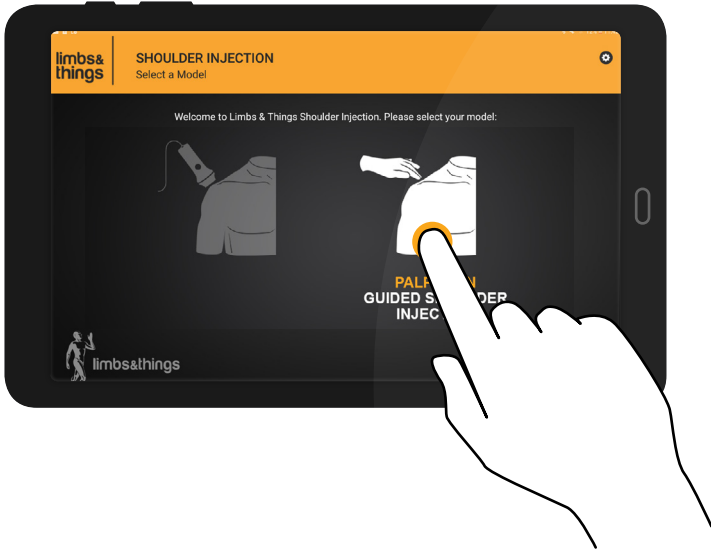

6 Select 'CONNECT MODEL'

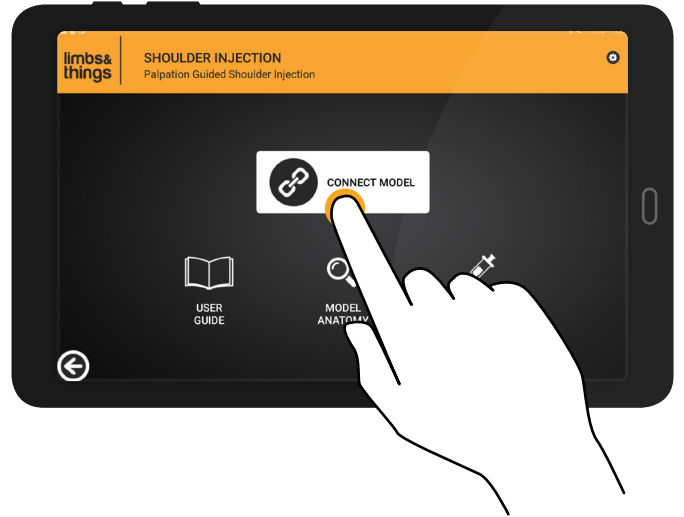

7 Choose the correct number as printed on the shoulder and select 'CONNECT'

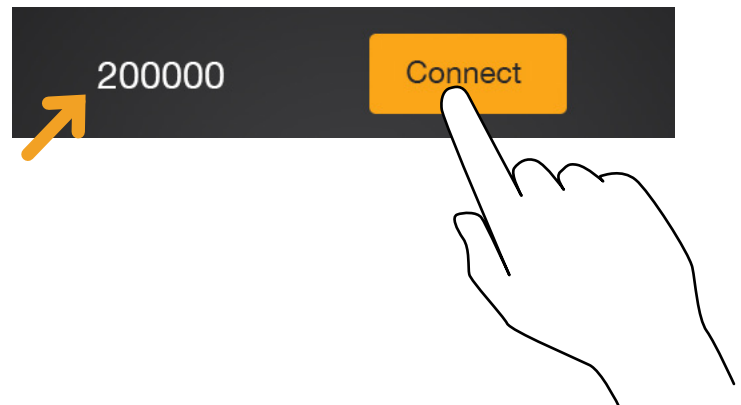

8 Select 'PRACTICE MODE'

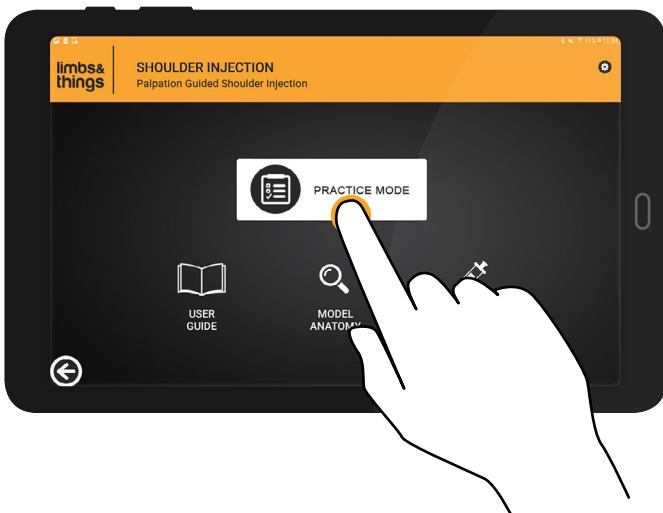

You can now start practicing

PRACTICING



Inject the shoulder

If you are correct, the app will light up and beep

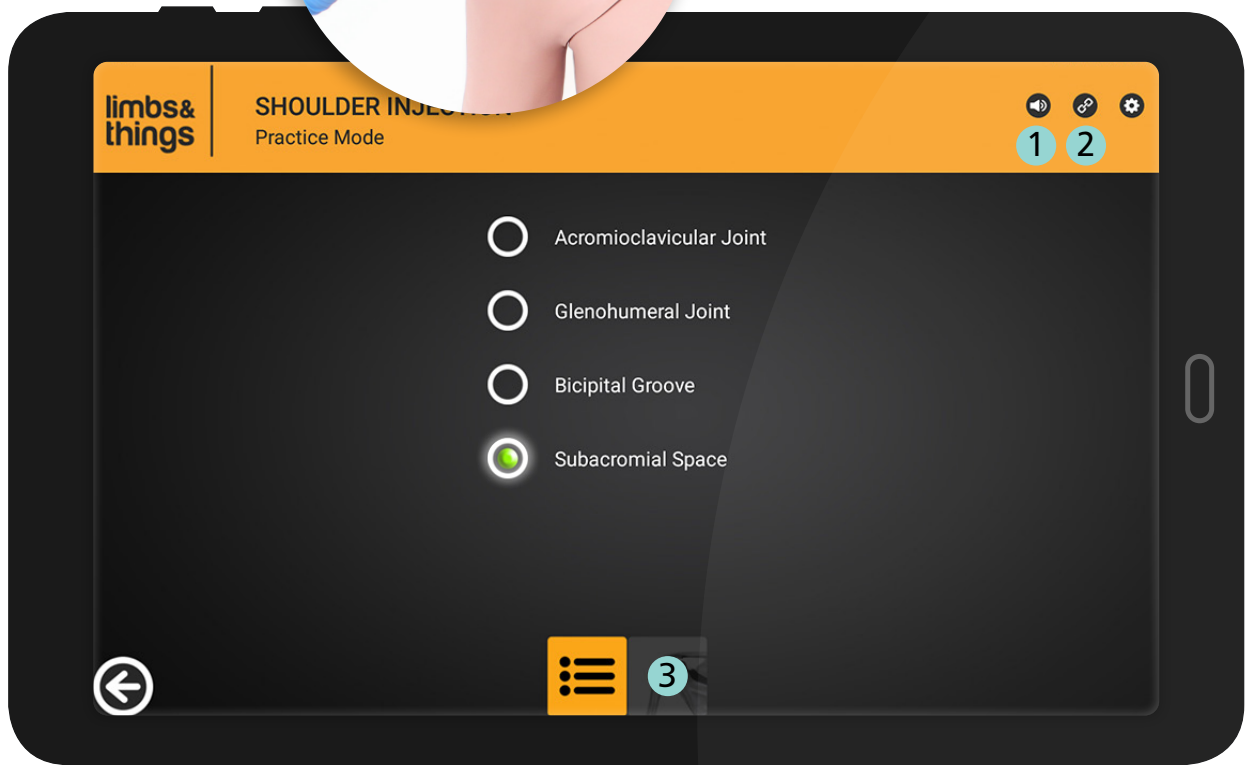

1 Audible feedback ON/OFF

2 Model CONNECTED/DISCONNECTED



3 List view/360° Anatomy view

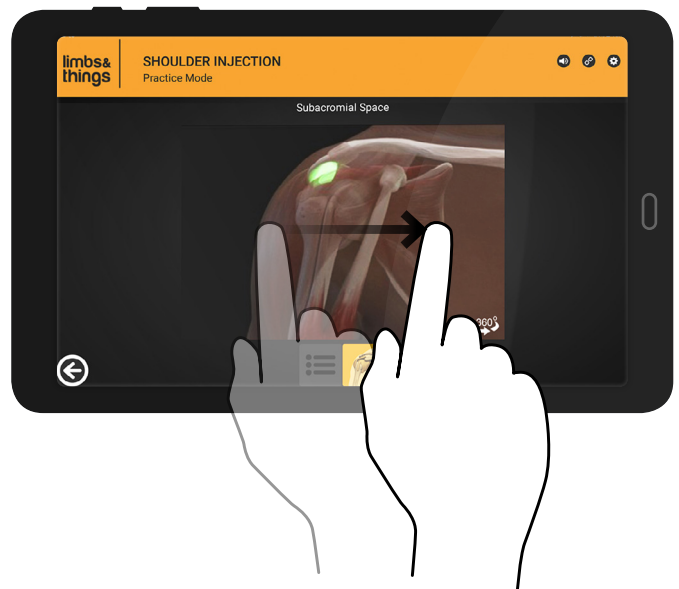
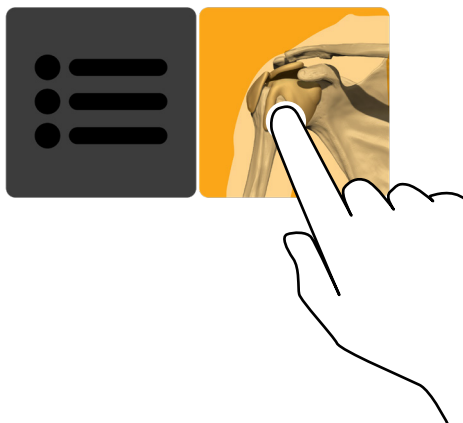

OTHER APP FEATURES

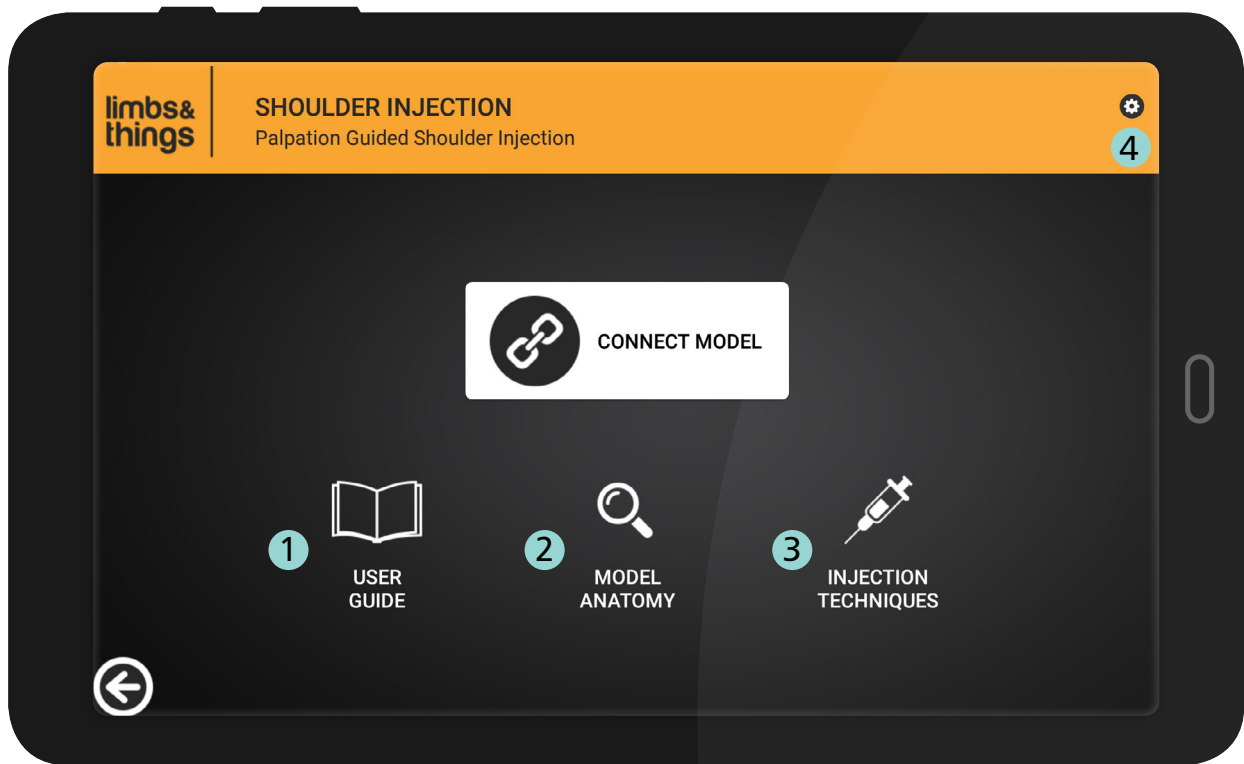

1 USER GUIDE

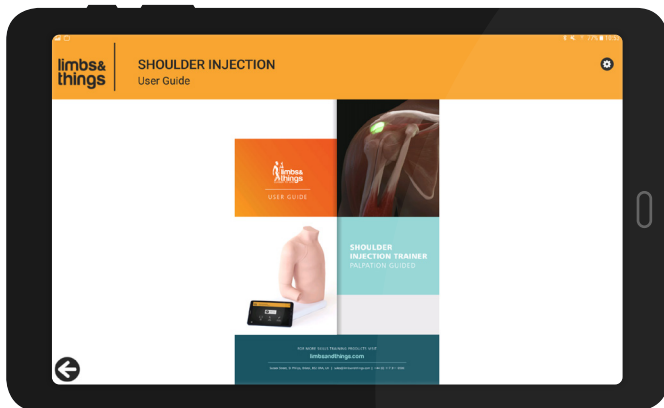

2 MODEL ANATOMY

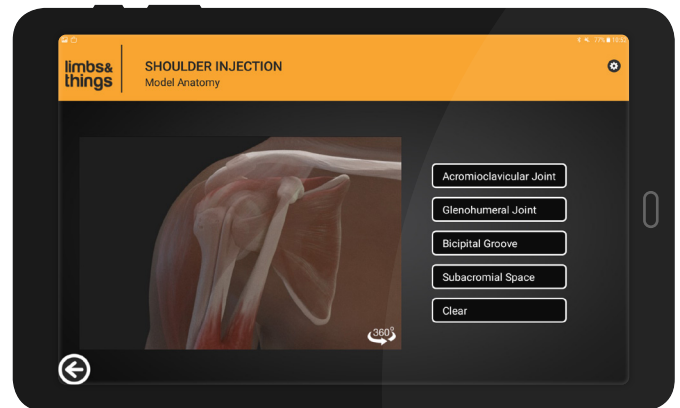

3 INJECTION TECHNIQUES

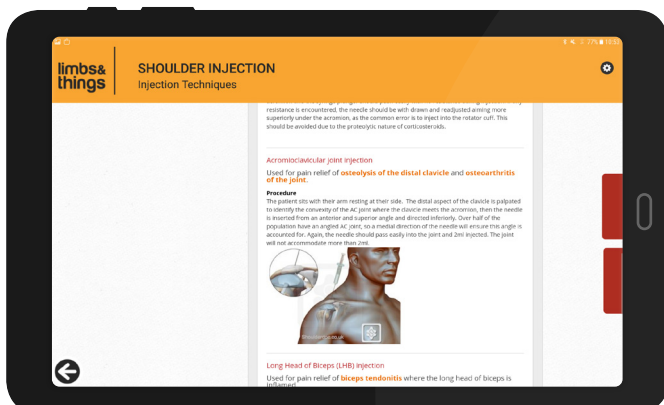

4 APP SETTINGS

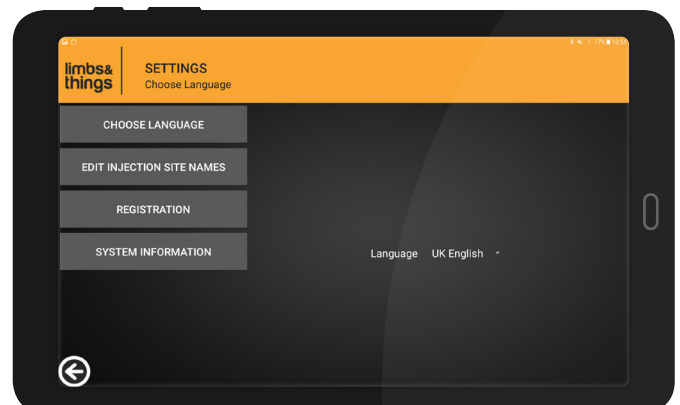

CARE & MAINTENANCE

REMOVE & REATTACH THE SHOULDER

1 Remove shoulder from torso

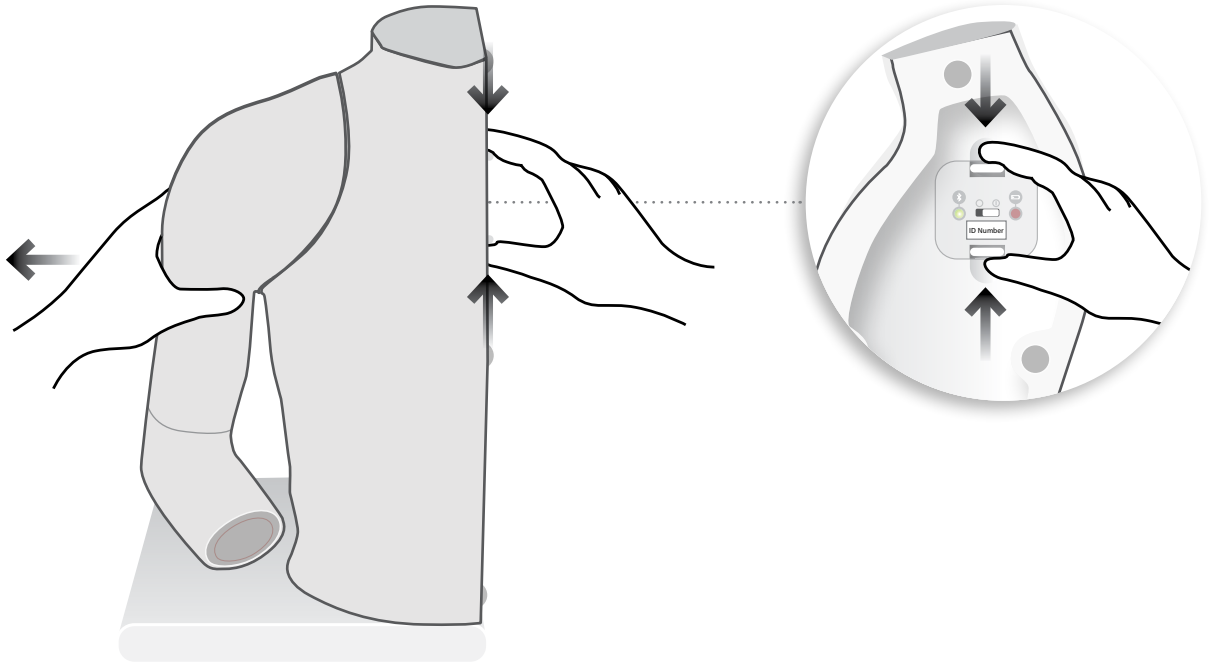

2 Mount shoulder into torso

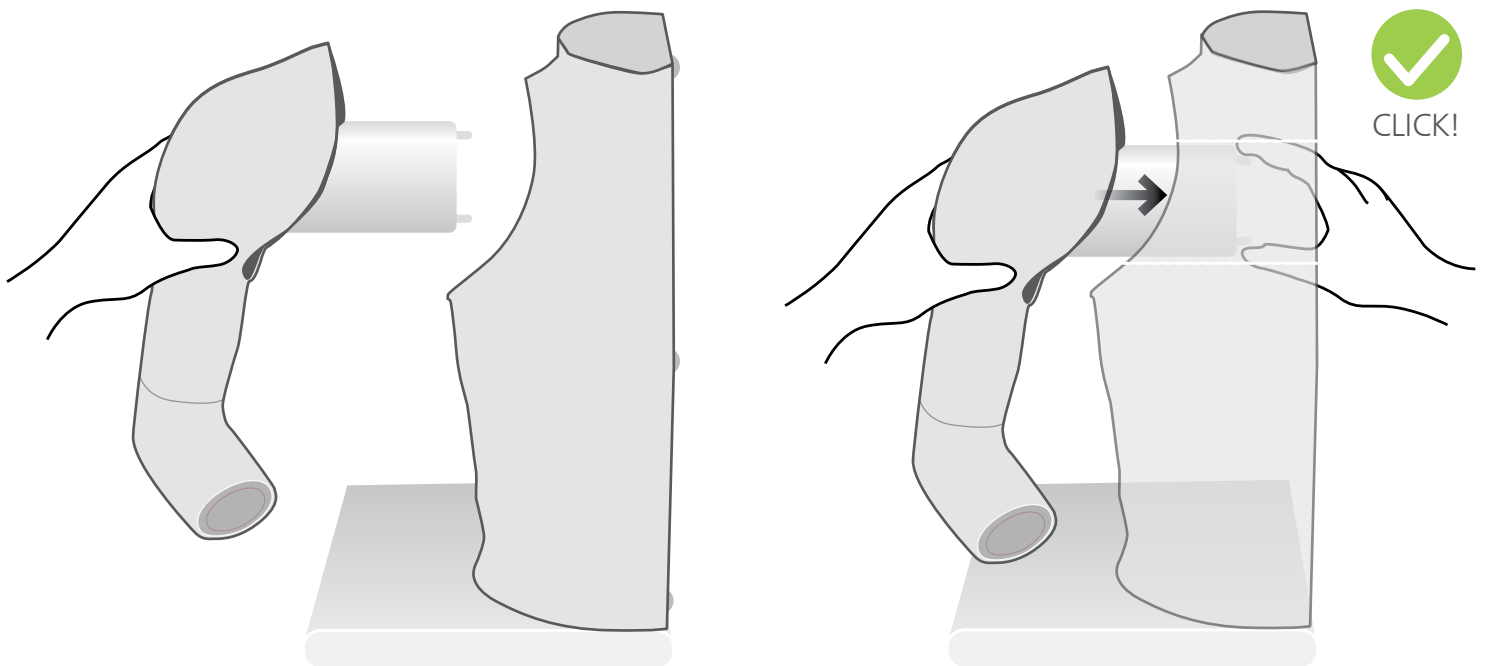

CHANGING THE SKIN

1 Remove elbow

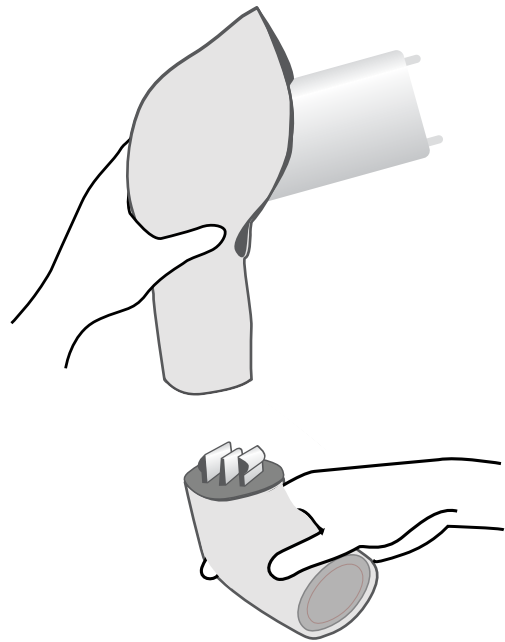
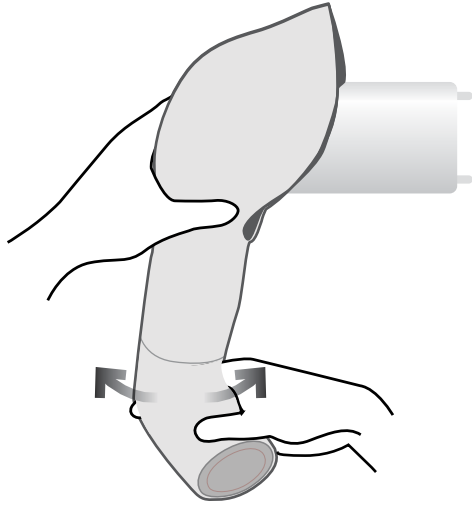

2 Peel off skin from top

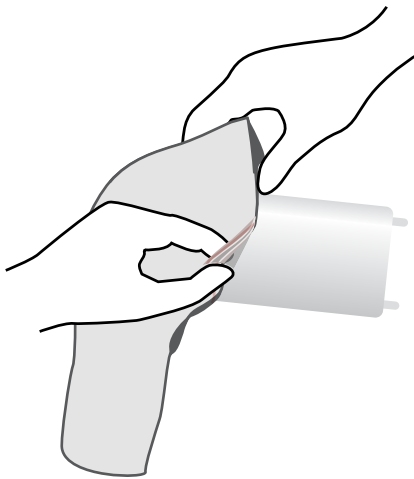

3 Push up humerus

4 Pull out humerus

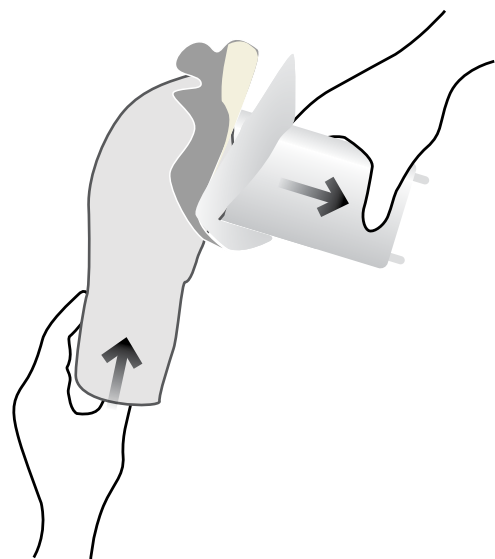

Ensure that you put the humerus into the new skin, with bicipital groove facing forwards

CHANGING THE BATTERIES

1 Battery warning notice



RED BATTERY LIGHT

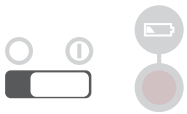

Batteries OK - No light

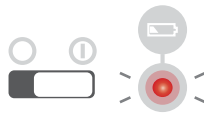

Low Battery - Light flashes slow



Batteries Run out - Light flashes fast and then model turns off

2

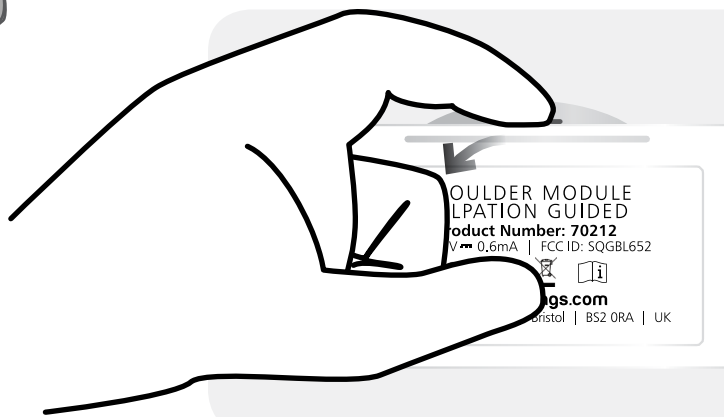
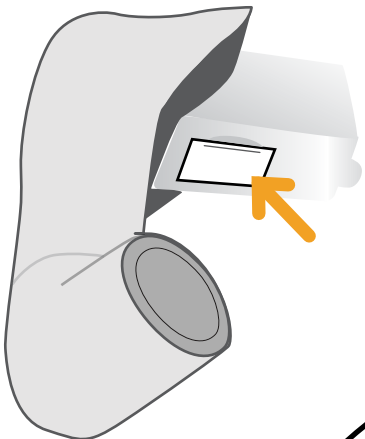

YOU MAY
ALSO BE
INTERESTED IN...

ULTRASOUND SHOULDER UPGRADE KIT

70214 **70225**



KNEE ASPIRATION & INJECTION TRAINER WITH ULTRASOUND CAPABILITY

70103 **70114**

